

ER CORE

TYPE	FIG.	Dimensions(mm)						
		A	B	C	D	E	F	G
ER11/5/6	1	10.8±0.3	2.45±0.15	5.9±0.2	4.15±0.2	8.85±0.3	1.575±0.15	
ER12/5/5	1	12.4±0.3	2.65±0.15	5.0±0.15	3.4±0.15	10.4min	1.75±0.15	
ER12.8/5/9	1	12.8±0.35	2.85±0.15	8.7±0.25	5.0±0.2	11.2±0.35	1.75±0.15	
ER14.5/6/7	2	14.5±0.35	2.95±0.15	6.7±0.2	4.7±0.2	11.8±0.3	1.65±0.15	
ER14.5/6/6	2	14.5±0.35	3.2±0.15	6.15±0.2	4.7±0.2	11.8±0.3	1.85±0.15	
ER18/6/10	1	18.0±0.4	3.15±0.15	9.7±0.3	6.2±0.2	15.15min	1.7±0.15	
ER18.5/10/12	2	18.5±0.4	4.8±0.15	12.0±0.3	6.2±0.2	15.15min	2.3±0.15	
ER20/7/14.6	1	19.3±0.4	3.56±0.15	14.6±0.35	7.62±0.25	16.76±0.4	1.76±0.15	
ER20/10/14	1	20.0±0.4	5.1±0.15	14.0±0.35	8.8±0.3	18.0±0.4	2.9±0.15	
ER20/12/14	1	20.0±0.4	6.1±0.15	14±0.35	8.8±0.3	18.0±0.4	4.0±0.15	
ER20/10/10	3	20.6±0.4	4.85±0.15	10.0±0.3	7.8±0.25	17.0±0.4	2.85±0.15	6±0.2
ER23/8/12.5	1	23.2±0.45	4.0±0.15	12.5±0.35	8.0±0.25	20.2±0.45	2.0±0.15	
ER25/10/10	1&2	25.4±0.5	5.2±0.15	10.0±0.3	8.3±0.3	18.6±0.5	3.05±0.15	
ER25/10/18	1	25.0±0.5	5.0±0.15	18.0±0.35	11.0±0.3	22.0±0.5	2.7±0.15	
ER25/10/20	2	25.0±0.5	4.85±0.15	20.0±0.4	9.8±0.3	21.2±0.5	3.05±0.15	
ER25/10.8/18	1	25.0±0.5	5.38±0.15	18.0±0.4	11.0±0.3	22.0±0.5	2.53±0.15	
ER25/12/20	2	25.0±0.5	6.1±0.15	20.0±0.4	9.8±0.3	21.2±0.5	4.2±0.15	
ER25/18/11	1	25.0±0.5	9.05±0.2	11.0±0.3	9.5±0.3	19.5±0.5	5.8±0.2	
ER27.6/12/15	2	27.6±0.6	5.7±0.15	15.0±0.35	11.35±0.3	20.8±0.6	3.2±0.15	
ER28.5/20/11	1	28.5±0.6	10.00±0.2	11.4±0.3	9.9±0.3	21.2min	6.5±0.2	
ER30/10/20	2	30.2±0.6	4.9±0.15	20.0±0.4	11.2±0.3	24.6min	2.3±0.15	
ER30/16/20	1	30.0±0.6	8.1±0.2	20.0±0.4	11.0±0.3	25.6min	5.5±0.2	
ER29.5/16/20	1	29.5±0.6	8.38±0.15	20.3±0.4	13.2±0.35	25.0±0.6	5.38±0.15	
ER30/18/20	1	30.0±0.6	9.4±0.2	20.3±0.4	13.25±0.35	25.0min	6.6±0.2	
ER31.5/22/20	1	31.5±0.6	10.8±0.2	20.3±0.4	13.3±0.35	26.9±0.6	7.8±0.2	
ER32/8/22	1	32.2±0.6	4.19±0.2	22.0±0.4	11.0±0.3	29.0±0.6	1.64±0.2	

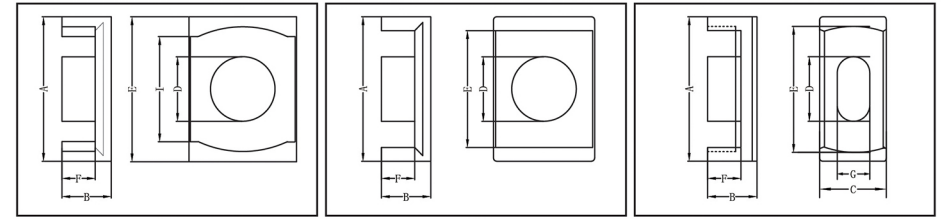
ER CORE

FIG.1

FIG.2

FIG.3

l	Cl (mm ²)	Ae (mm ²)	Le (mm)	Ve (mm ³)	AL ± 25% (nH/N ²)			Weight g/PRS
					FW40	FW44	FW95	
7.9min	1.12	12.58	14.05	176.8	1200	1250	1400	0.9
	1.87	9.35	17.49	163.5	800	850	950	0.84
9.05±0.35	0.78	20.85	16.36	341.1	1850	1900	2200	2.1
	1.08	17.55	19.00	333.4	1450	1500	1750	1.7
	1.18	16.79	19.88	333.7	1350	1400	1600	1.7
13.5min	0.7	30.01	21.05	631.8	4100	4300	5900	3.4
	0.61	40.55	24.80	1005.5	2850	2950	3500	7.0
15.5±0.4	0.37	54.92	20.20	1109.5	4400	4500	5250	3.2
12.86±0.35	0.45	59.45	26.90	1599.1	3400	4100	4950	8.8
12.86±0.35	0.53	58.54	31.14	1823.1	3600	3700	4500	9.9
	0.68	41.29	27.98	1155.4	2700	2780	3350	5.6
17.5min	0.52	51.15	26.77	1369.1	3450	3550	4250	8.1
15.5min	0.58	52.03	30.30	1576.7	3250	3350	4050	8.7
14.5min	0.31	93.41	28.53	2665.1	6050	6200	7500	14.2
	0.44	73.82	32.49	2398.6	4400	4500	5500	12.9
14.5min	0.29	100.64	28.79	2896.9	6450	6650	8000	20.8
	0.49	75.82	37.26	2825.2	4100	4250	5200	15.2
16.9min	0.66	67.19	44.68	3001.9	3450	3550	4450	16.6
	0.39	86.96	33.65	2926.2	5050	5200	6350	16.2
19.5±0.4	0.65	77.77	50.64	3939.0	3600	3700	4650	20.8
	0.34	101.85	34.48	3511.5	5800	6000	7250	19.5
19.15min	0.41	107.59	44.10	4744.9	5150	5300	6650	25.7
20.0±0.6	0.31	138.45	42.33	5860.9	5200	5500	8750	30.7
20.4±0.4	0.35	135.24	47.47	6419.2	5000	5200	7950	35.0
	0.39	138.03	54.22	7484.3	5650	5850	7400	37.6
23±0.4	0.28	112.56	31.21	3512.4	6900	7050	8600	20.2